

Alternative Table Layouts

Alternative Layout A

"Caterpillar" Layout up to 42 guests (4-8 max tables) (based on 5 guests each table, 6 guests on end tables)

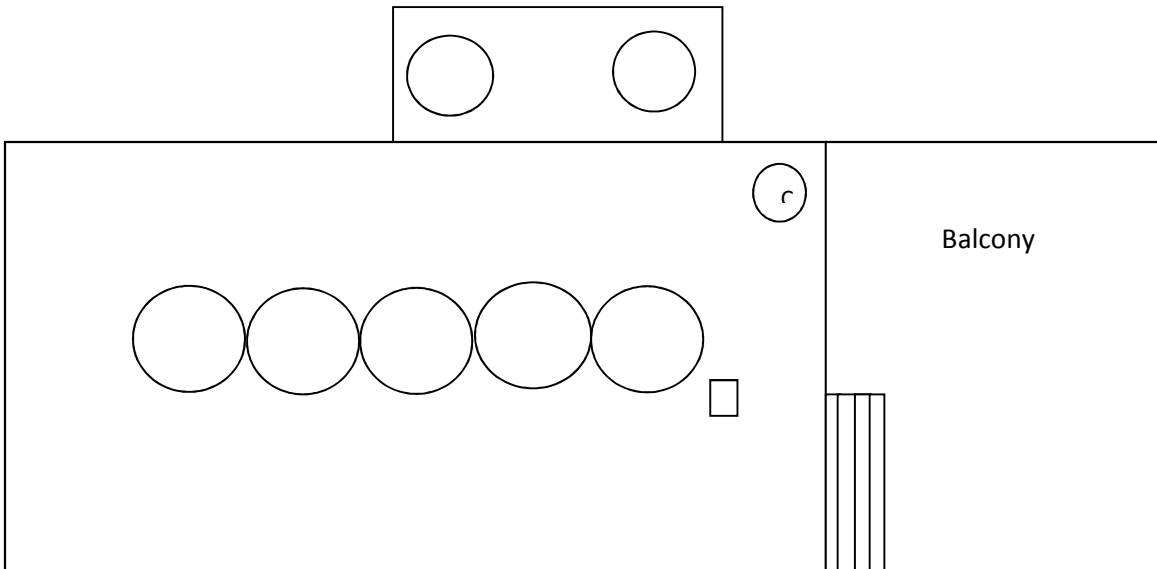

Alternative Layout B Max = (18ft) Top 1 x 10 persons + 2 if on ends

$$9 \times 12's = 108$$

$$2 \times 8's = 16$$

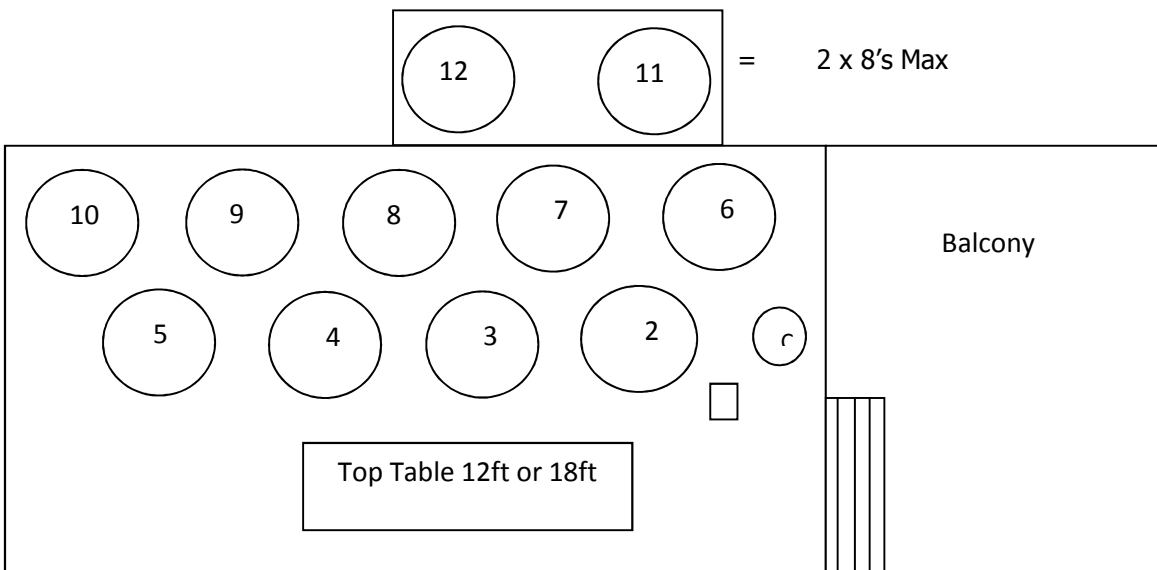

Alternative Layout C Winter Only Max = (12ft) Top 1 x 6 persons + 2 if on ends
12 x 12's = 144

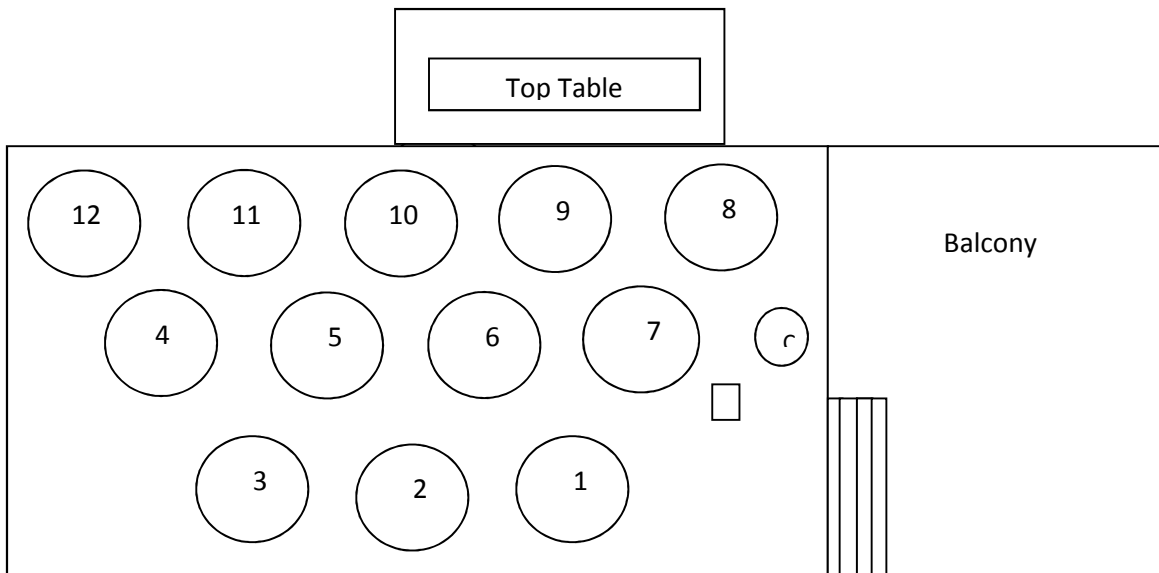

Main Table Layout D Max Seating = 172 13 x 12's = 156
2 x 8's = 16

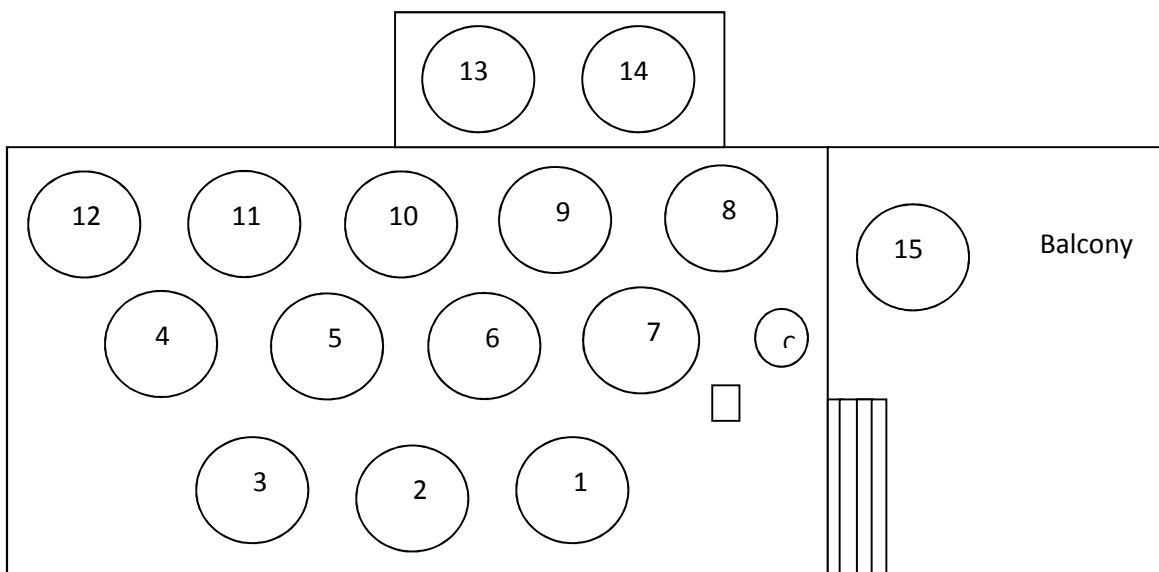

Alternative Layout E

Max = (12ft) Top 1 x 12
 9 x 12's = 108
 2 x 8's = 16 Maximum 136

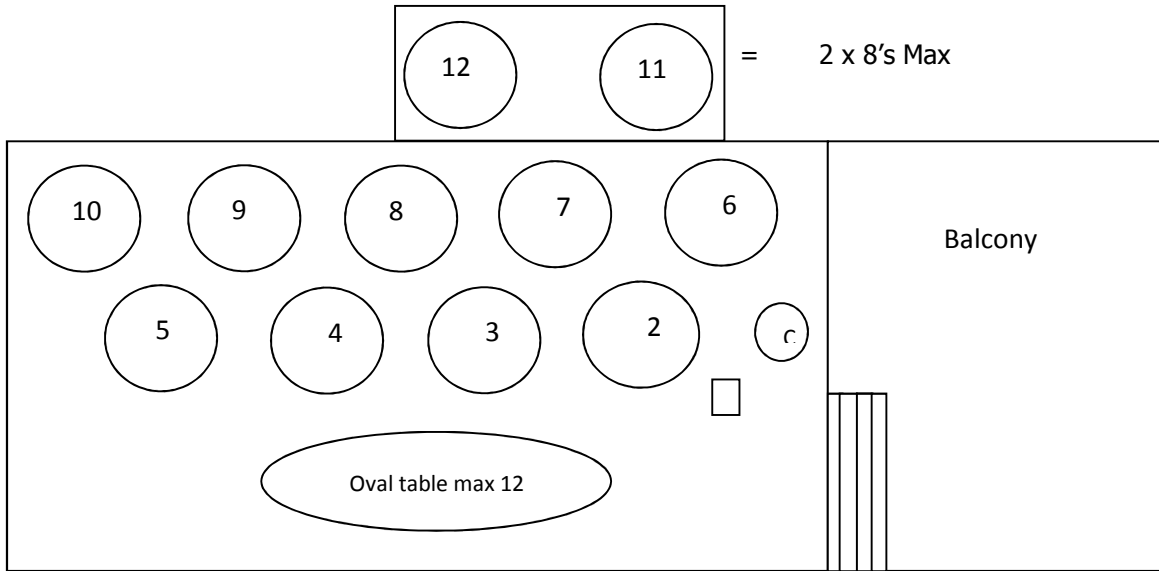

Alternative Layout F

Max = (12ft) Top 1 x 12
 11 x 12's = 122
 2 x 8's = 16. Maximum 150

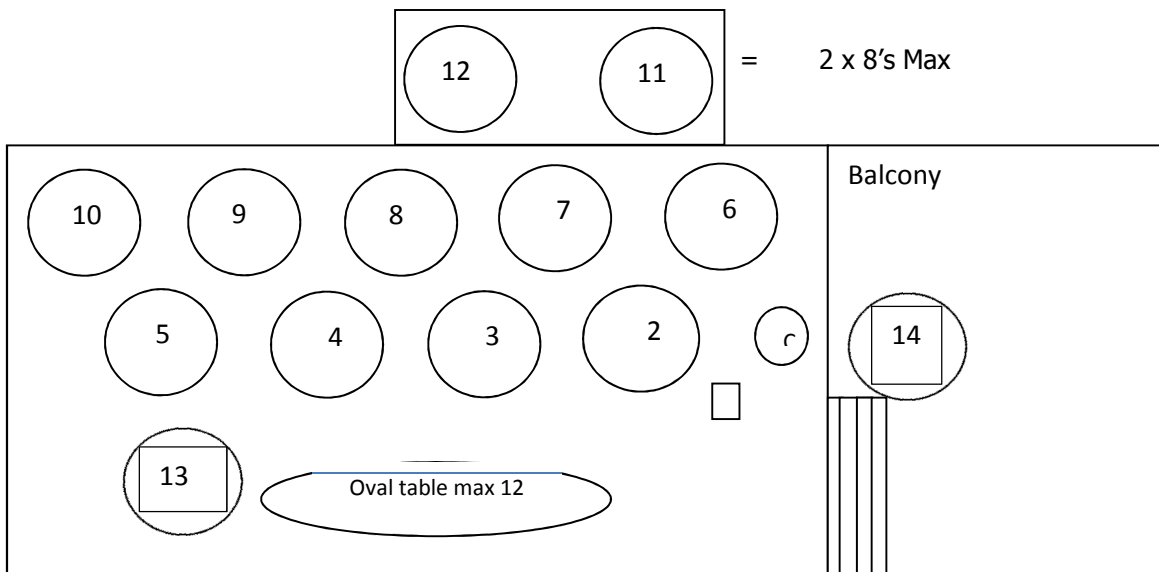



Notes: The above layouts are suggestions only, please discuss directly with Pendrell Hall for alternatives.

